

# Riverside Avenue Industrial

For Lease – 300,564 SF

SWC RIVERSIDE AVENUE AND JURUPA AVENUE, RIALTO, CA



## Property Features:

- Building Area: 300,564 SF
- Site Area: 13.79 Acres
- Office Size: To Suit
- Dock High Loading: 53: 9' x 10'
- Grade Level Loading: 3: 12' x 14'
- Clear Height: 32' Minimum
- Trailer Storage: 59 Spaces
- Truck Yard Depth: 175'
- Skylights: 3%
- Fire Protection: ESFR
- Bay Spacing: 52' x 50' Typical
- Power: 4,000 Amp Capacity

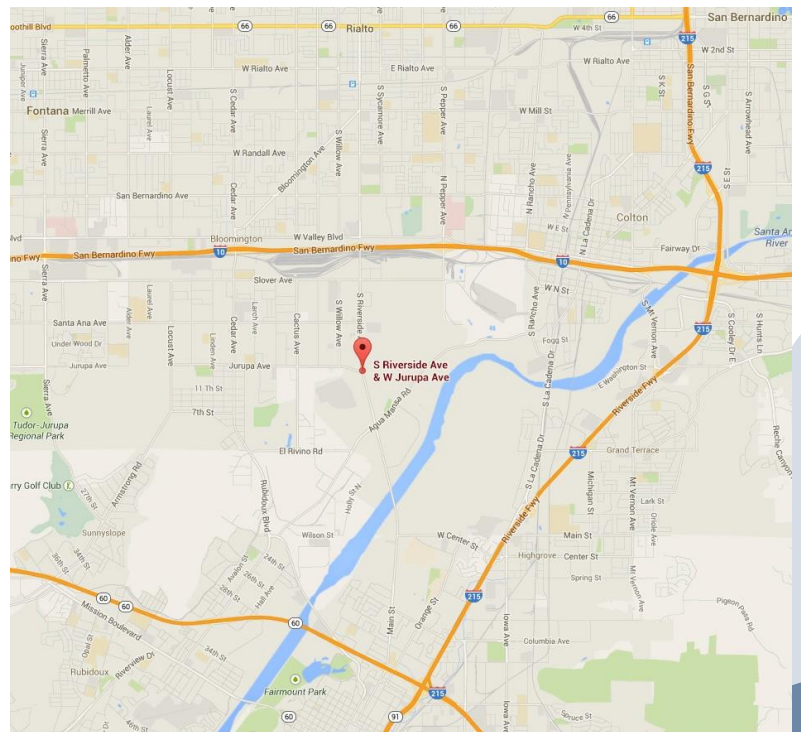

# Riverside Avenue Industrial

For Lease – 300,564 SF

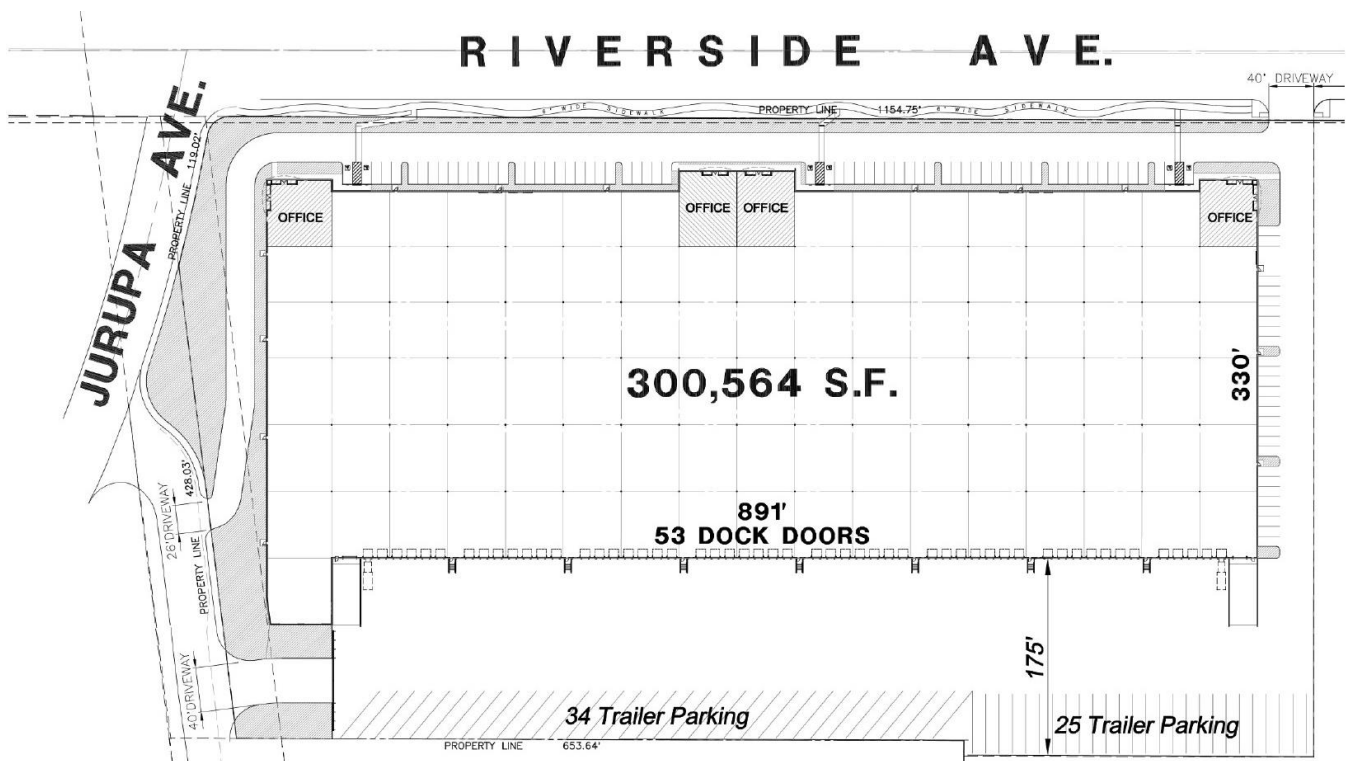

**For more information, please contact:**

Jeff Smith  
909.989.7771 x189  
jsmith@lee-assoc.com

Shane Strickland  
909.989.771 x262  
sstrickland@lee-assoc.com